

1

CROSS SECTION AT EXISTING SINGLE STORY  
3/8" = 1' - 0"

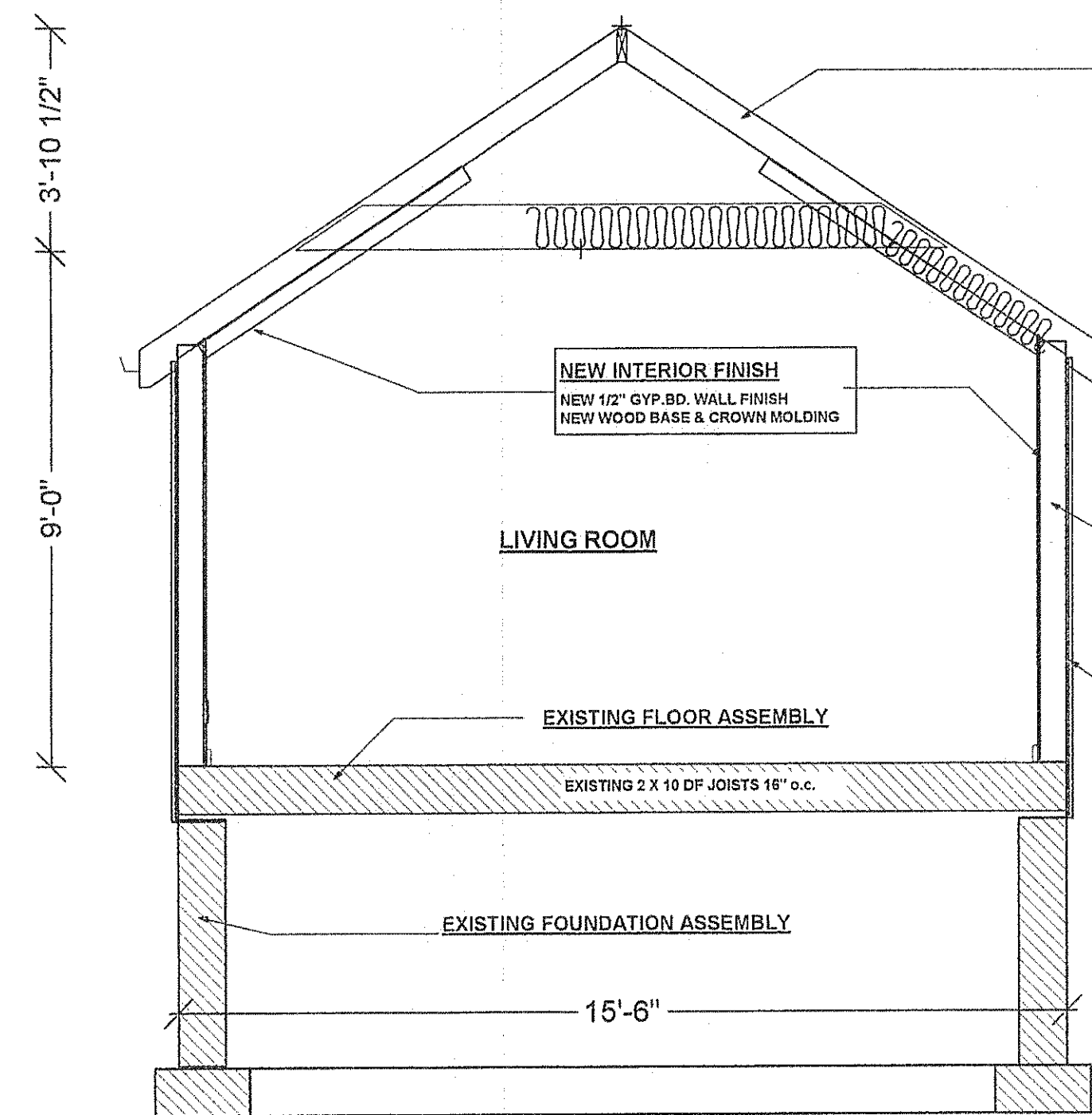

- ROOF ASSEMBLY**  
EXISTING RIDGE  
EXISTING 2" X 6" RAFTERS @ 16" o.c.  
EXISTING CONTINUOUS RIDGE VENT  
EXISTING ROOF SYSTEM (TO REMAIN)  
NEW 2 X 10 DF #2 CEILING JOIST 16" OC  
NEW RAFTER TO CEILING JOIST CONNECTION - SEE CONNECTION SCHEDULE DRAWING S-1  
NEW - FRAME DOWN EACH EXISTING RAFTER W/ 2x4 FOR R-30 INSULATION IN ATTIC AND RAFTER SPACE  
NEW RIGID Baffle TO MAINTAIN 1" MIN. AIRSPACE  
NEW HURRICANE CLIPS AT EACH RAFTER TO TOP PLATE - SIMPSON #H9  
NEW 1/2" GYPSUM WALLBOARD @ CEILING
- NEW EAVE ASSEMBLY**  
2" WHITE ALUMINUM DRIP EDGE  
5" ALUMINUM "OGEE" GUTTERS WITH ALUMINUM LEADERS  
4" ALUMINUM SOFFIT VENTS
- NEW WINDOWS AND WINDOW OPENINGS**  
(2) 2" X 10" HEADER W/ 1/2" PLYWOOD FILLER (TYP. TO 6")  
EXTERIOR WINDOW TRIMS AND CASING TO BE PVC MATERIAL  
STRAPPING @ WINDOW OPENINGS - SEE DRAWING S-1 & S-2  
WINDOW HIGH WIND RATING SHALL BE 30 +
- EXTERIOR WALL ASSEMBLY**  
2 X 4 STUDS 16" o.c. @ EXISTING EXTERIOR WALLS  
NEW - FURR OUT TO MATCH 2x4 WALLS  
NEW TOP & BOTTOM PLATE TO STUD CONNECTION - SP-4  
NEW R-19 FIBERGLASS INSULATION @ EXTERIOR WALLS  
NEW TYVEK HOUSE WRAP  
EXISTING 1x TAG SHEATHING  
NEW VINYL SIDING AND TRIM
- NEW INTERIOR FINISH**  
NEW 1/2" GYP. BD. WALL FINISH  
NEW WOOD BASE & CROWN MOLDING
- EXISTING FLOOR ASSEMBLY**  
EXISTING 2 X 10 DF JOISTS 16" o.c.
- EXISTING FOUNDATION ASSEMBLY**

2

CROSS SECTION AT EXISTING THREE STORY  
3/8" = 1' - 0"

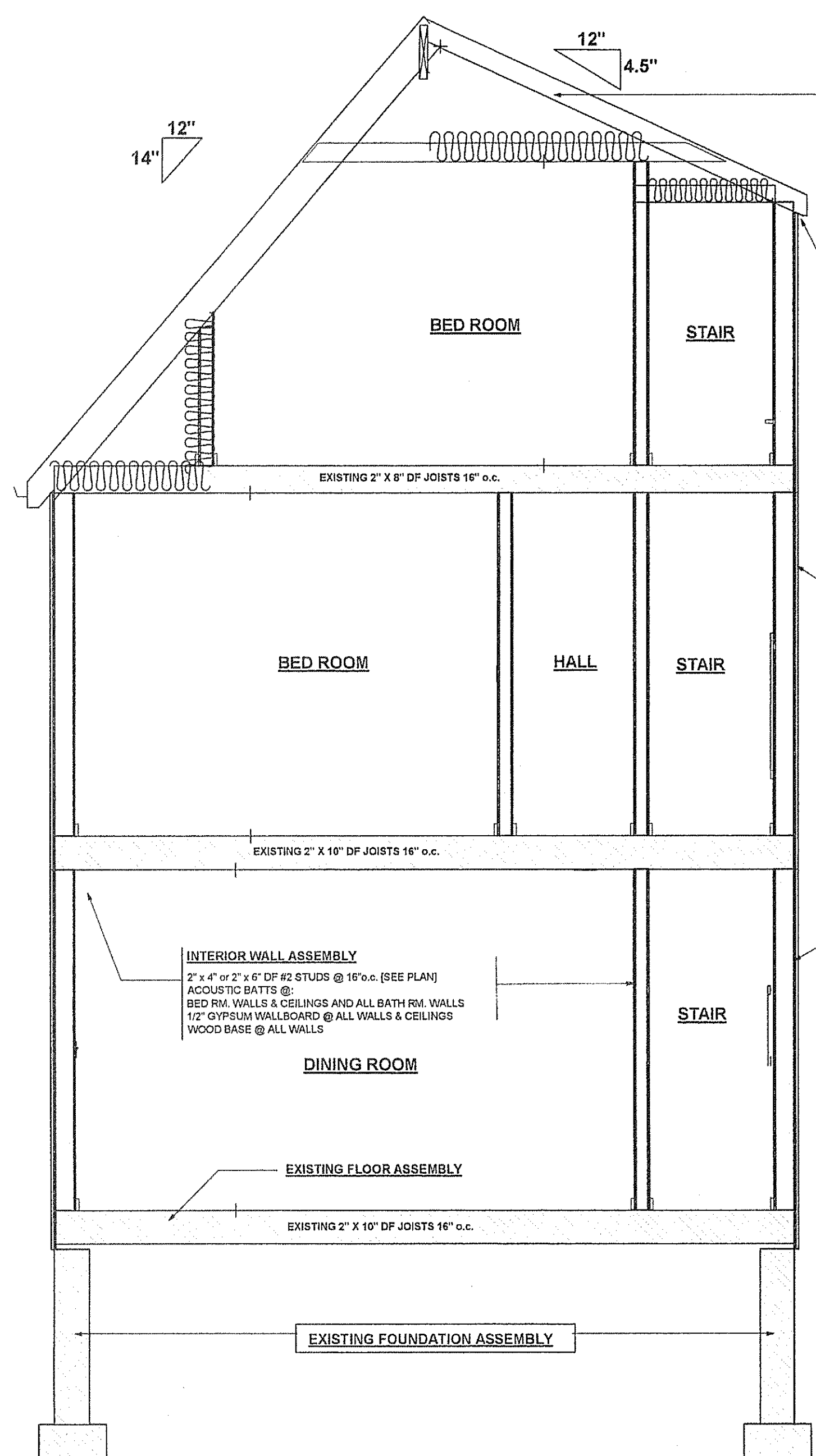

- ROOF ASSEMBLY**  
EXISTING 2 X 12 LVL RIDGE  
EXISTING CONTINUOUS RIDGE VENT  
EXISTING 2 X 6 DF #2 RAFTERS 16" OC  
NEW 2 X 6 DF #2 CEILING JOIST 16" OC  
EXISTING RAFTER TO CEILING JOIST CONNECTION - CONTRACTOR TO VERIFY (DWG S-1)  
NEW R-30 BATT INSULATION @ ATTIC SPACE  
NOTE: ATTIC WITHOUT STORAGE - INSULATION BETWEEN FRAMING MEMBERS WILL BE PARTIALLY ABOVE CEILING JOISTS  
NEW RIGID Baffle TO MAINTAIN 1" MIN. AIRSPACE  
EXISTING HURRICANE CLIPS AT EACH RAFTER TO TOP PLATE - CONTRACTOR TO VERIFY (DWG S-1)
- NEW EAVE ASSEMBLY**  
2" WHITE ALUMINUM DRIP EDGE  
5" ALUMINUM "OGEE" GUTTERS WITH ALUMINUM LEADERS  
4" ALUMINUM SOFFIT VENTS
- NEW & EXISTING WINDOWS AND WINDOW OPENINGS**  
(2) 2" X 10" HEADER W/ 1/2" PLYWOOD FILLER (TYP. TO 6")  
EXTERIOR WINDOW TRIMS AND CASING TO BE FIBERGLASS MATERIAL PER MFG.  
NEW STRAPPING @ WINDOW OPENINGS - SEE DRAWING S-1  
WINDOW HIGH WIND RATING SHALL BE 30 +
- EXISTING EXTERIOR WALL ASSEMBLY**  
EXISTING TOP & BOTTOM PLATE TO STUD CONNECTION - CONTRACTOR TO VERIFY (DWG S-1)  
EXISTING ROOF TO WALL ASSEMBLY CONNECTION - CONTRACTOR TO VERIFY (DWG S-1)  
2 X 4 STUDS 16" o.c. @ NEW EXTERIOR WALLS  
2 X 4 STUDS 16" o.c. @ EXISTING EXTERIOR WALLS  
EXISTING 1/2" PLYWOOD SHEATHING - NOTE: CONTRACTOR TO REPLACE ANY EXISTING DAMAGED SHEATHING - CONTRACTOR TO VERIFY MAILING PATTERN (DWG S-1)  
NEW TYVEK HOUSE WRAP  
NEW VINYL SIDING  
NEW R-19 FIBERGLASS INSULATION @ EXIST. EXTERIOR WALLS
- INTERIOR WALL ASSEMBLY**  
2" x 4" or 2" x 6" DF #2 STUDS @ 16" o.c. (SEE PLAN)  
ACOUSTIC BATT @:  
BED RM WALLS & CEILINGS AND ALL BATH RM WALLS  
1/2" GYPSUM WALLBOARD @ ALL WALLS & CEILINGS  
WOOD BASE @ ALL WALLS
- EXISTING FLOOR ASSEMBLY**  
EXISTING 2" X 10" DF JOISTS 16" o.c.
- EXISTING FOUNDATION ASSEMBLY**

DRAWING No:

A - 4

DATE: 01-28-2009  
SCALE: AS NOTED

**TOBIN RENOVATION**  
79 BOTSFORD AVENUE  
MILFORD, CONNECTICUT

**JLG Designs, LLC**

INTERIORS & BUILDING DESIGNS  
Milford, Connecticut 06460  
Phone: 203-370-2095  
E-mail: jlg-design@juno.com  
CT REGISTERED INTERIOR DESIGNER AND CT LICENSED BUILDING OFFICIAL

REVISIONS:

THIS DRAWING IS THE PROPERTY OF THE DESIGNER. IT IS TO BE USED ONLY FOR THE PROJECT AND LOCATION SPECIFICALLY IDENTIFIED HEREON. IT IS NOT TO BE REPRODUCED, COPIED, OR OTHERWISE TRANSMITTED IN ANY FORM OR BY ANY MEANS, ELECTRONIC OR MECHANICAL, WITHOUT THE WRITTEN PERMISSION OF THE DESIGNER.