

| ROOM FINISH SCHEDULE |       |      |       |    |    |    |         |                 |  |
|----------------------|-------|------|-------|----|----|----|---------|-----------------|--|
| ROOM NAME            | FLOOR | BASE | WALLS |    |    |    | CEILING | REMARKS         |  |
|                      |       |      | N     | E  | S  | W  |         |                 |  |
| BED 1                | F4    | B3   | W4    | W4 | W4 | W4 | C3      | PAINT ALL WALLS |  |
| BED 2                | F4    | B3   | W4    | W4 | W4 | W4 | C3      | *CEILING*       |  |
| BED 3                | F4    | B3   | W4    | W4 | W4 | W4 | C3      |                 |  |
| BATH 2               | F5    | B5   | W7    | W7 | W7 | W7 | C5      |                 |  |
| HALF BATH            | F5    | B5   | W4    | W4 | W4 | W4 | C3      |                 |  |
| HALL 2               | F6    | B3   | W4    | W4 | W4 | W4 | C3      |                 |  |
| DECK                 | F7    | B-   | -     | -  | -  | -  | -       | 'TREX'          |  |
| HALL 3               | F4    | B3   | W4    | W4 | W4 | W4 | C3      |                 |  |

| ROOM FINISH SCHEDULE LEGEND      |                                     |
|----------------------------------|-------------------------------------|
| <b>FLOOR</b>                     | <b>BASE</b>                         |
| F1 EXISTING TO REMAIN            | B1 EXISTING TO REMAIN               |
| F2 MATCH EXISTING                | B2 MATCH EXISTING                   |
| F3 CONCRETE                      | B3 4" HARDWOOD                      |
| F4 CARPET W/ PADDING             | B4 4" VINYL COVE                    |
| F5 CERAMIC TILE                  | B5 4" TILE                          |
| F6 T&G RED OAK HARDWOOD FLOORING | B6 4" CARPET W/ TOP EDGE BOUND      |
| F7 COMPOSITE DECKING             | B7                                  |
| F8                               | B8                                  |
| <b>WALLS</b>                     | <b>CEILING</b>                      |
| W1 EXISTING TO REMAIN            | C1 EXISTING TO REMAIN               |
| W2 MATCH EXISTING                | C2 MATCH EXISTING                   |
| W3 1/2" R. GYP. BD.              | C3 1/2" GYP. BD.                    |
| W4 1/2" GYP. BD.                 | C4 5/8" FIRE RATED GYP. BD.         |
| W5 WAINSCOT PANELING             | C5 LAY-IN AGUS, CEILING GRID & TILE |
| W6 CERAMIC TILE                  | C6 T&G HARDWOOD                     |
| W7                               | C7                                  |
| W8                               | C8                                  |

| DOOR SCHEDULE |       |        |       |           |         |      |                             |  |  |
|---------------|-------|--------|-------|-----------|---------|------|-----------------------------|--|--|
| NO.           | DOOR  |        | HW.   | DP RATING | CASINGS |      | REMARKS                     |  |  |
|               | WIDTH | HEIGHT |       |           | TYPE    | FIN. |                             |  |  |
| 01            | 2-6   | 6-8    | 1 3/8 | LD MFG    | B       | 30   | CS-1 PAINT FRENCH STYLE     |  |  |
| 02            | 2-6   | 6-8    | 1 3/8 | LD PAINT  | D       | -    | CS-3 "                      |  |  |
| 03            | 3-0   | 6-8    | 1 3/8 | LD PAINT  | E       | -    | CS-3 "                      |  |  |
| 04            | 3-0   | 6-8    | 1 3/8 | LD PAINT  | E       | -    | CS-3 "                      |  |  |
| 05            | 4-0   | 6-8    | 1 3/8 | LD PAINT  | G       | -    | CS-3 " (2) B.FOLD. LAMINATE |  |  |
| 06            |       |        |       |           |         |      |                             |  |  |
| 07            |       |        |       |           |         |      |                             |  |  |

| DOOR HARDWARE LEGEND |   |
|----------------------|---|
| A                    | ELECTRIC OVERHEAD DOOR OPERATOR W/ REMOTES, INTERIOR PUSH BUTTON CONTROL, EXTERIOR KEYSWITCH, AND SAFETY BEAM SYSTEM  |
| B                    | LOCKSET, AS FUNCTION W/ THUMB TURN INSIDE, DEADBOLT W/ THUMB TURN INSIDE, PERMETER WEATHER STRIPPING, BRASS THRESHOLD, 1/2" PR. BRASS BUTT HINGE, LEVER STYLE HANDLE                              |
| C                    | LOCKSET, AS FUNCTION W/ THUMB TURN INSIDE, DEADBOLT W/ THUMB TURN INSIDE, PERMETER WEATHER STRIPPING, BRASS THRESHOLD, 1/2" PR. BRASS BUTT HINGE, 1 SPRING SELF-CLOSING HINGE, LEVER STYLE HANDLE |
| D                    | LATCHSET, PRIVACY FUNCTION, 1/2" PR. BUTT HINGE, LEVER STYLE HANDLE   |
| E                    | LATCHSET, PASSAGE FUNCTION, 1/2" PR. BUTT HINGE, LEVER STYLE HANDLE   |
| F                    | BY-PASS DOOR FRAME ASSEMBLY, RECESSED DOOR PULLS  |
| G                    | BIFOLD DOOR FRAME ASSEMBLY, DOOR PULL KINGS   |

| CASING LEGEND |                   |
|---------------|-------------------|
| CS-1          | EXTERIOR INTERIOR |
| CS-2          | EXTERIOR          |
| CS-3          | INTERIOR          |

A = PER OWNER SELECTION

| WINDOW SCHEDULE |               |          |      |        |           |      |         |       |             |
|-----------------|---------------|----------|------|--------|-----------|------|---------|-------|-------------|
| NO.             | ROUGH OPENING |          | TYPE | FINISH | DP RATING | ZONE | CASINGS |       | REMARKS     |
|                 | WIDTH         | HEIGHT   |      |        |           |      | TYPE    | FIN.  |             |
| 01              | 1'-10 1/2"    | 3'- 1/4" | DH   | MFG    | 40        | 5    | CS-1    | PAINT | 'ITDH 223C' |
| 02              |               |          |      |        |           |      |         |       |             |
| 03              |               |          |      |        |           |      |         |       |             |
| 04              | 3'- 1/2"      | 5'- 1/4" | DH   | MFG    | 40        | 4    | CS-1    | PAINT | 'ITDH 3660' |
| 05              |               |          |      |        |           |      |         |       |             |
| 07              |               |          |      |        |           |      |         |       |             |
| 08              |               |          |      |        |           |      |         |       |             |

NOTES:  
 PROVIDE AND INSTALL 'INTEGRITY' WOOD-ULTRIX SERIES WINDOWS  
 3/4" INSULATING GLASS WITH LOXE & ARGON GAS FILL U-FACTOR OF < .40  
 REMOVABLE FIBERGLASS FULL SCREENS, ALL OPERABLE UNITS  
 WOOD INTERIOR / FIBERGLASS EXTERIOR  
 WINDOW HARDWARE COLOR - WHITE

| CASING LEGEND |                   |
|---------------|-------------------|
| CS-1          | EXTERIOR INTERIOR |
| CS-2          | EXTERIOR          |
| CS-3          | INTERIOR          |

A = PER OWNER SELECTION

**DRAWING NOTES**

**WALL TYPES:**

W1 EXISTING EXTERIOR 2x4 FRAMED WALL W/ 1/2" SHEATHING - EXISTING SIDING AND INTERIOR WALL FINISHES TO BE REMOVED - FURFOUT TO EQUAL 2x6 FRAMING NEW WEATHER RESISTANT SHEATHING PAPER, NEW VINYL SIDING AND TRIM, NEW R-19 INSULATION, NEW 1/2" GYP. BD. WALL ON INTERIOR

W2 EXISTING INTERIOR 2x6 FRAMED WALL W/ PLYWOOD SHEATHING - EXISTING PLYWOOD TO BE REMOVED, REFRAME FOR NEW DOORWAY, NEW 1/2" GYP. BD. WALL FINISH

W3 EXISTING EXTERIOR 2x6 FRAMED WALL W/ 1/2" PLYWOOD SHEATHING - NEW WEATHER RESISTANT SHEATHING PAPER, NEW VINYL SIDING & TRIM, NEW R-19 INSULATION, NEW 1/2" IR GYP. BD. WALL AND DURA-ROCK BD. ON INTERIOR - (NOTE: CONTRACTOR TO INSTALL HORIZONTAL BLOCKING AT SHEATHING JOINTS)

W4 NEW INTERIOR 2x4 FRAMED WALL W/ 1/2" IR GYP. BD. & DURA-ROCK ON BATHROOM SIDE; 1/2" GYP. BD. ON OTHER SIDE; INSTALL BLOCKING FOR WAINSCOT PANELING

W5 NEW INTERIOR 2x4 FRAMED WALL W/ 1/2" GYP. BD. & DURA-ROCK ON ONE SIDE WITH 1/2" GYP. BD. ON THE OTHER; INSTALL BLOCKING FOR KITCHEN CABINETS

W6 NEW 2x4 FRAMED WALL - 1/2" GYP. BD. ON BOTH SIDES

W7 EXISTING EXTERIOR 2x6 FRAMED WALL W/ 1/2" PLYWOOD SHEATHING - NEW WEATHER RESISTANT SHEATHING PAPER, NEW VINYL SIDING & TRIM, NEW R-19 INSULATION, NEW 1/2" GYP. BD. WALL ON INTERIOR - (NOTE: CONTRACTOR TO INSTALL HORIZONTAL BLOCKING AT SHEATHING JOINTS)

W8 NEW INTERIOR 2x4 FRAMED DOUBLE WALL W/ 1/2" IR GYP. BD. & DURA-ROCK ON BATHROOM SIDE AND 1/2" GYP. BD. ON THE OTHER; INSTALL BLOCKING FOR WAINSCOT PANELING

W9 NEW INTERIOR 2x6 FRAMED WALL W/ 1/2" IR GYP. BD. ONE SIDE AND DURA-ROCK ON THE OTHER; INSTALL BLOCKING FOR WAINSCOT PANELING

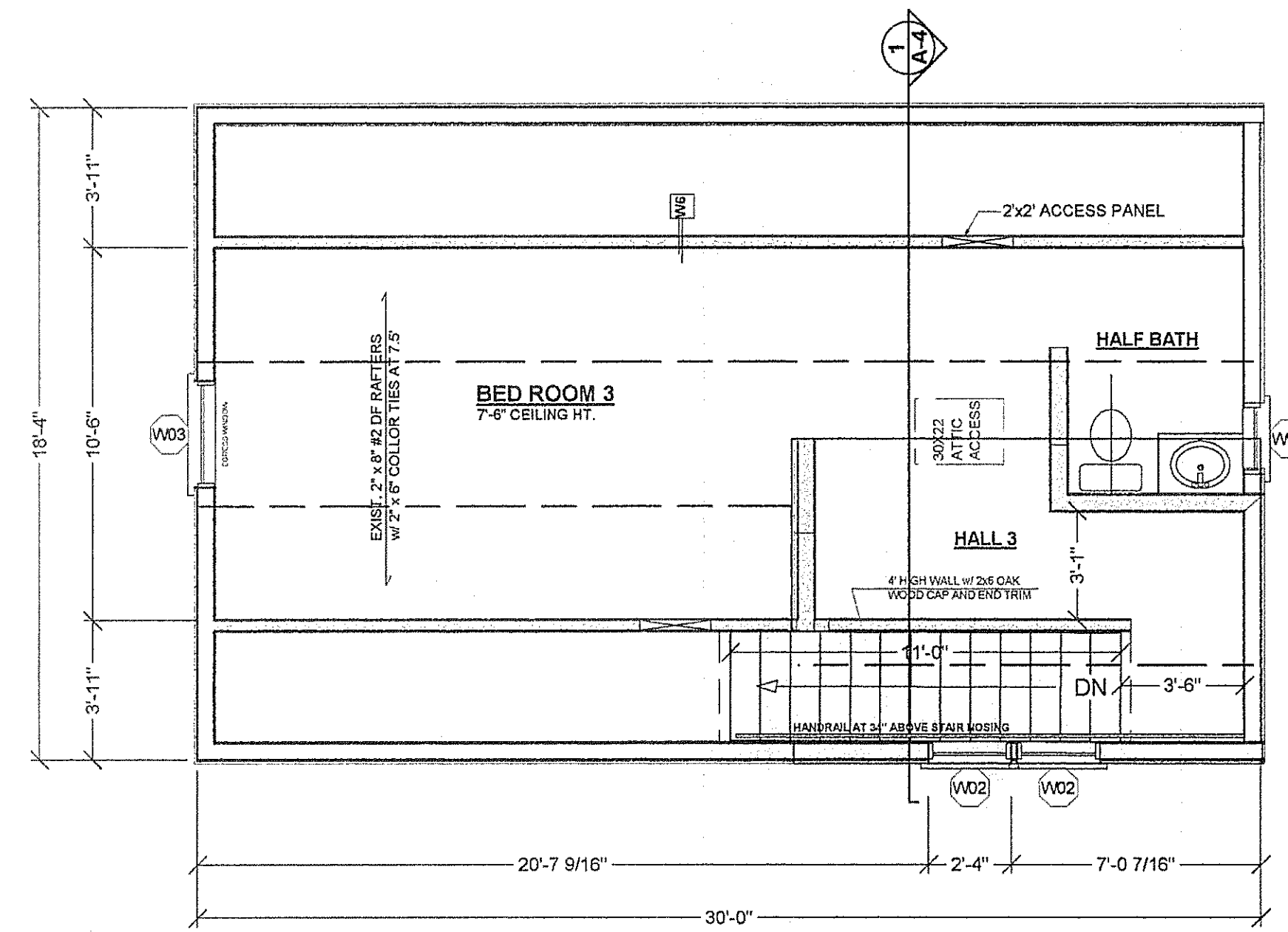

**2** **THIRD FLOOR PLAN**  
1/4" = 1' - 0"

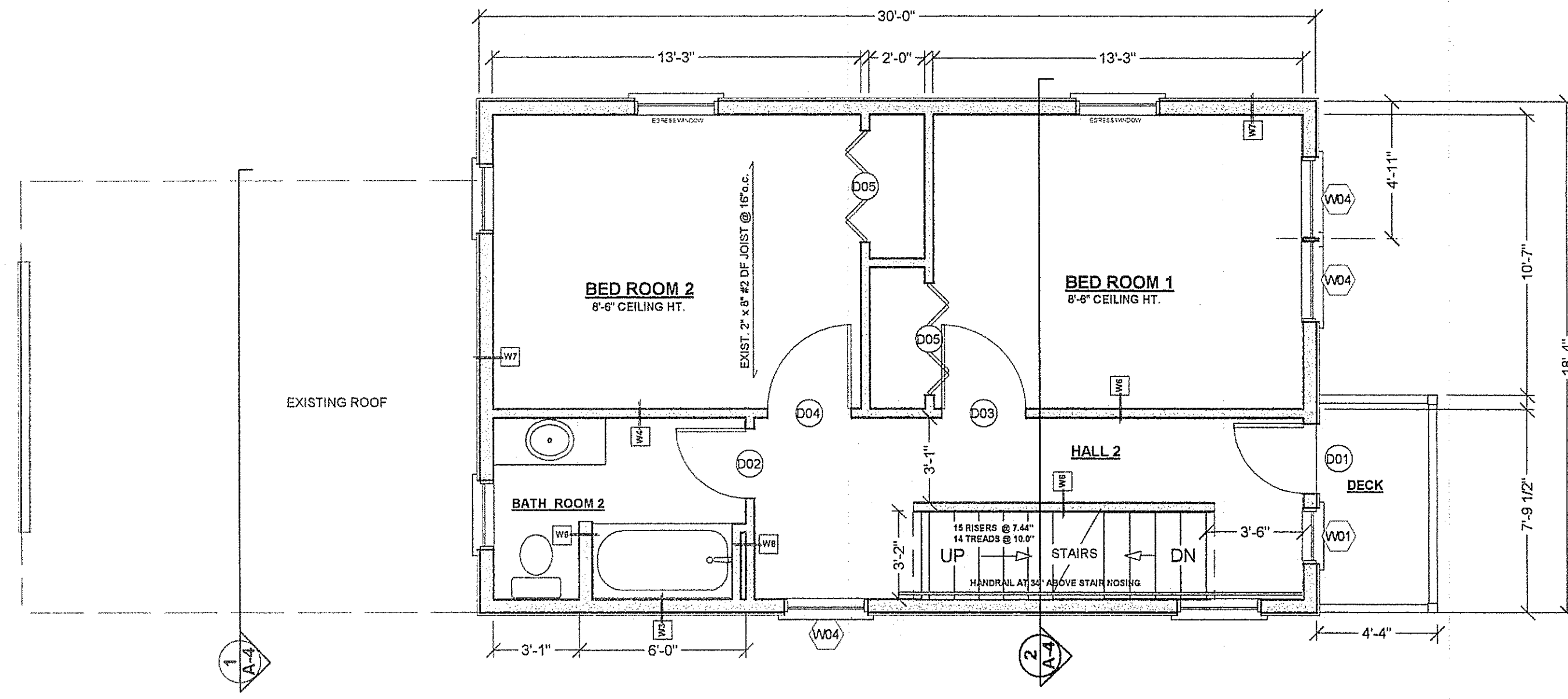

**1** **SECOND FLOOR PLAN**  
1/4" = 1' - 0"

**JLG Designs, LLC**  
 INTERIORS & BUILDING DESIGNS  
 Milford, Connecticut 06460  
 Phone: 203-876-2095  
 E-mail: jlg-design@juno.com  
 CT REGISTERED INTERIOR DESIGNER AND CT LICENSED BUILDING OFFICIAL

---

**TOBIN RENOVATION**  
 79 BOTSFORD AVENUE  
 MILFORD, CONNECTICUT

---

DRAWING No: **A - 2**  
 DATE: 01-28-2009  
 SCALE: AS NOTED